

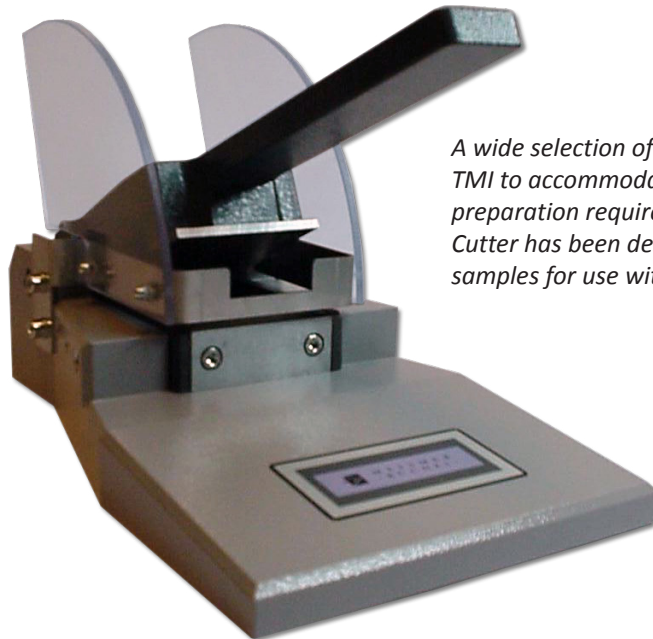

# Specimen Cutter for Elmendorf Tear Tester

Model 83-20-08



*A wide selection of cutters are available from TMI to accommodate all of your sample preparation requirements. The 83-20 Specimen Cutter has been designed to cut accurate samples for use with the Elmendorf Tear Tester.*

The Specimen Cutter, with its triple shear cutting blade and rigid construction, produces precise samples in a simple, reliable manner. This accuracy in sample preparation adds to the overall dependability of the test procedure and ensures repeatable results every time.

This cutter is very easy-to-use with simple operation and produces **2.5 x 3.0 in. (63 x 76 mm)** test pieces.

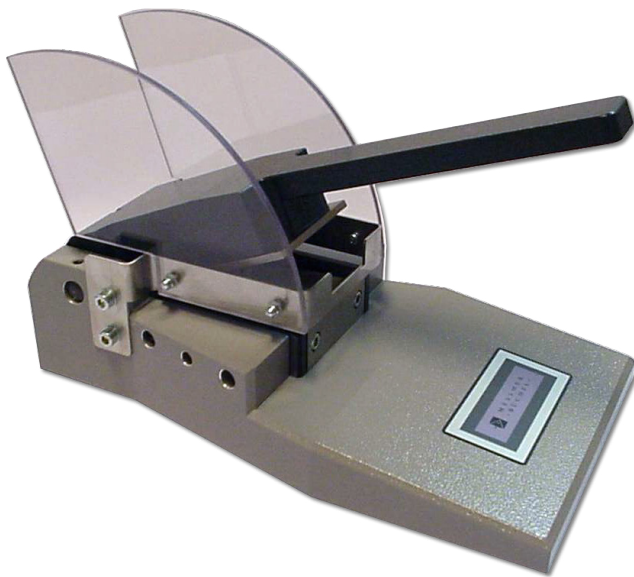

## FEATURES

- Produces 2.5 x 3.0 in. (63 x 76 mm) test pieces
- Self-adjusted knives assure cutting of test piece
- Supplied with safety guard
- Automatic sample lifting device
- Wide working range
- High precision
- Easy to use
- Rigid construction

## SPECIFICATIONS

- Depth: 300 mm (11.8 in.)
- Height: 170 mm (6.7 in.)
- Width: 160 mm (6.3 in.)
- Weight: 5 Kg (11 lbs.)

## STANDARDS

Meets EN/ISO 1974, NFQ.03.011, NEN 1760, TAPPI T414, SCAN P11, ASTM D689, AS/NZS 1301.400S and other technically equivalent standards



TESTING MACHINES, INC.

Phone: 1-302-613-5600 Fax: 1-302-613-5619  
info@testingmachines.com

Visit us online: [www.testingmachines.com](http://www.testingmachines.com)



©2018 Testing Machines, Inc. All rights reserved.  
Specifications subject to change.